

# Short Environmental Assessment Form

## Part 1 - Project Information

### Instructions for Completing

**Part 1 – Project Information.** The applicant or project sponsor is responsible for the completion of Part 1. Responses become part of the application for approval or funding, are subject to public review, and may be subject to further verification. Complete Part 1 based on information currently available. If additional research or investigation would be needed to fully respond to any item, please answer as thoroughly as possible based on current information.

Complete all items in Part 1. You may also provide any additional information which you believe will be needed by or useful to the lead agency; attach additional pages as necessary to supplement any item.

<b>Part 1 – Project and Sponsor Information</b>			
Name of Action or Project: New Hampton Fire District Property Purchase			
Project Location (describe, and attach a location map): 5030 Route 17M, New Hampton, New York			
Brief Description of Proposed Action: Purchase of approximately .77 acre property within a single story office building that is adjacent to New Hampton Fire District firehouse.			
Name of Applicant or Sponsor: New Hampton Fire District		Telephone: 845-374-2111	
		E-Mail: nhfc@hvc.rr.com	
Address: 5024 State Route 17 M			
City/PO: New Hampton		State: NY	Zip Code: 10958
1. Does the proposed action only involve the legislative adoption of a plan, local law, ordinance, administrative rule, or regulation? If Yes, attach a narrative description of the intent of the proposed action and the environmental resources that may be affected in the municipality and proceed to Part 2. If no, continue to question 2.			NO <input type="checkbox"/>
			YES <input type="checkbox"/>
2. Does the proposed action require a permit, approval or funding from any other government Agency? If Yes, list agency(s) name and permit or approval:			NO <input type="checkbox"/>
			YES <input type="checkbox"/>
3. a. Total acreage of the site of the proposed action?		.77 acres	
b. Total acreage to be physically disturbed?		0 acres	
c. Total acreage (project site and any contiguous properties) owned or controlled by the applicant or project sponsor?		1.8 acres	
4. Check all land uses that occur on, are adjoining or near the proposed action:			
5. <input type="checkbox"/> Urban <input type="checkbox"/> Rural (non-agriculture) <input type="checkbox"/> Industrial <input checked="" type="checkbox"/> Commercial <input checked="" type="checkbox"/> Residential (suburban)			
<input type="checkbox"/> Forest <input type="checkbox"/> Agriculture <input type="checkbox"/> Aquatic <input type="checkbox"/> Other(Specify):			
<input type="checkbox"/> Parkland			

5. Is the proposed action,	NO	YES	N/A
a. A permitted use under the zoning regulations?	<input type="checkbox"/>	<input checked="" type="checkbox"/>	<input type="checkbox"/>
b. Consistent with the adopted comprehensive plan?	<input type="checkbox"/>	<input checked="" type="checkbox"/>	<input type="checkbox"/>
6. Is the proposed action consistent with the predominant character of the existing built or natural landscape?	NO	YES	
	<input type="checkbox"/>	<input checked="" type="checkbox"/>	
7. Is the site of the proposed action located in, or does it adjoin, a state listed Critical Environmental Area?	NO	YES	
If Yes, identify: _____	<input checked="" type="checkbox"/>	<input type="checkbox"/>	
8. a. Will the proposed action result in a substantial increase in traffic above present levels?	NO	YES	
	<input checked="" type="checkbox"/>	<input type="checkbox"/>	
b. Are public transportation services available at or near the site of the proposed action?	<input type="checkbox"/>	<input checked="" type="checkbox"/>	
c. Are any pedestrian accommodations or bicycle routes available on or near the site of the proposed action?	<input checked="" type="checkbox"/>	<input type="checkbox"/>	
9. Does the proposed action meet or exceed the state energy code requirements?	NO	YES	
If the proposed action will exceed requirements, describe design features and technologies: _____ _____	<input checked="" type="checkbox"/>	<input type="checkbox"/>	
10. Will the proposed action connect to an existing public/private water supply?	NO	YES	
If No, describe method for providing potable water: _____ Private Well	<input checked="" type="checkbox"/>	<input type="checkbox"/>	
11. Will the proposed action connect to existing wastewater utilities?	NO	YES	
If No, describe method for providing wastewater treatment: _____ Private septic System	<input checked="" type="checkbox"/>	<input type="checkbox"/>	
12. a. Does the project site contain, or is it substantially contiguous to, a building, archaeological site, or district which is listed on the National or State Register of Historic Places, or that has been determined by the Commissioner of the NYS Office of Parks, Recreation and Historic Preservation to be eligible for listing on the State Register of Historic Places?	NO	YES	
	<input checked="" type="checkbox"/>	<input type="checkbox"/>	
b. Is the project site, or any portion of it, located in or adjacent to an area designated as sensitive for archaeological sites on the NY State Historic Preservation Office (SHPO) archaeological site inventory?	<input checked="" type="checkbox"/>	<input type="checkbox"/>	
13. a. Does any portion of the site of the proposed action, or lands adjoining the proposed action, contain wetlands or other waterbodies regulated by a federal, state or local agency?	NO	YES	
	<input checked="" type="checkbox"/>	<input type="checkbox"/>	
b. Would the proposed action physically alter, or encroach into, any existing wetland or waterbody?	<input checked="" type="checkbox"/>	<input type="checkbox"/>	
If Yes, identify the wetland or waterbody and extent of alterations in square feet or acres: _____ _____ _____			



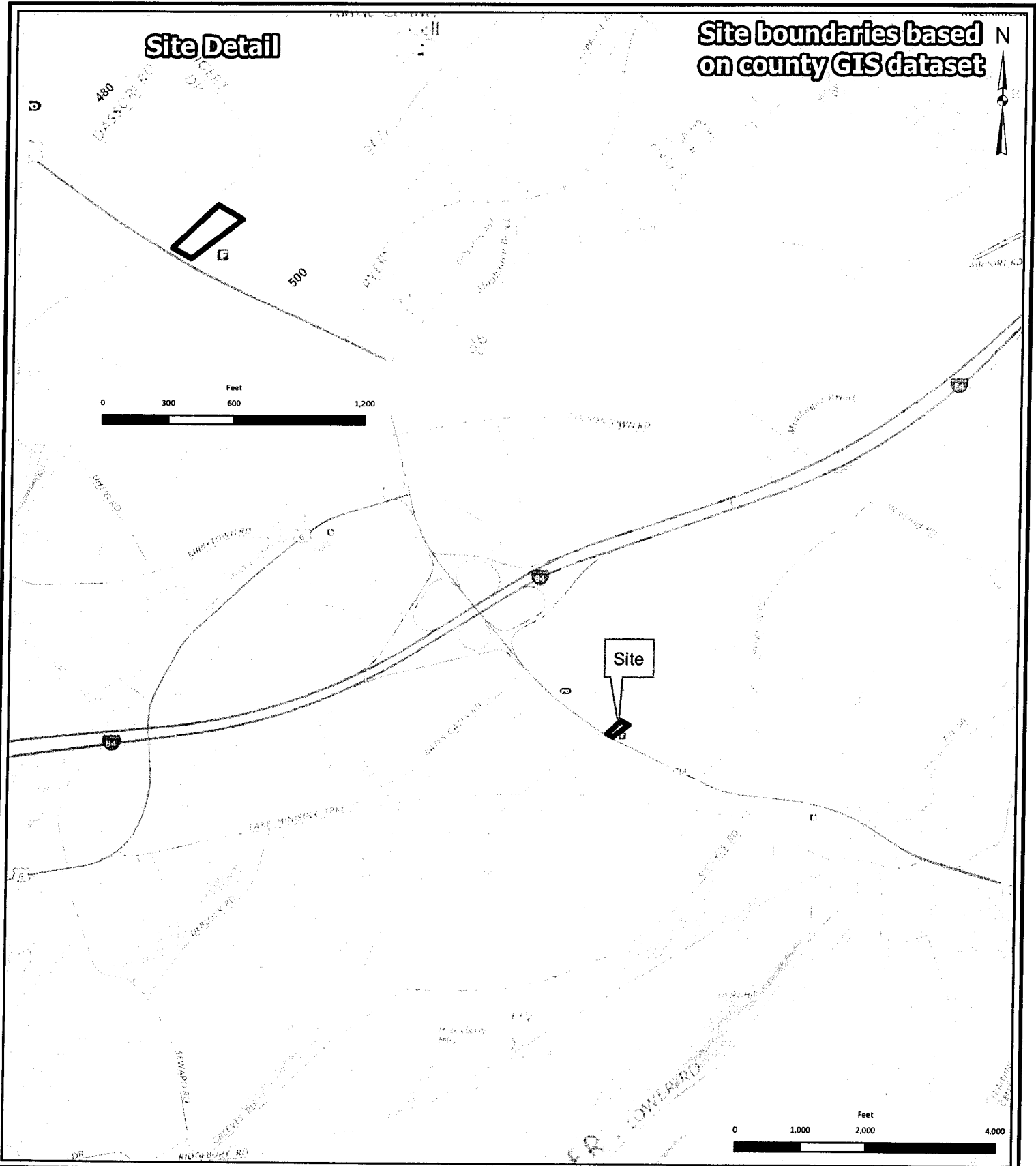

THE  
**Chazen**  
COMPANIES

ENGINEERS  
LAND SURVEYORS  
PLANNERS  
ENVIRONMENTAL & SAFETY PROFESSIONALS  
LANDSCAPE ARCHITECTS

**Dutchess County Office:**  
21 Fox Street, Poughkeepsie, NY 12601  
Phone: (845) 454-3980

**Capital District Office:**  
547 River Street, Troy, NY 12180  
Phone: (518) 273-0055

**North Country Office:**  
375 Bay Road, Queensbury, NY 12804  
Phone: (518) 812-0513

**5030 LLC Property**

**Figure 1: Site Location Map**

5030 Route 17M  
Town of Wawayanda, Orange County, NY

Source: Orange County 2016 Tax Parcel Dataset;  
US Topo, 2018 - USGSTopo (MapServer) Layer: USGS TNM Topo Base Map. Accessed 23 July 2019

Drawn:	MO
Date:	7/23/2019
Scale:	1 inch equals 2,000 feet
Project:	41916.01
Figure:	1